

Flip up



Flip-up

MELAMINE FACED CHIPBOARD (MFC) TOPS

30mm easy to clean scratch-resistant anti-reflective melamine faced chipboard (MFC) tops finished with 2mm matching straight ABS impact resistant edges. Panel density: 670/730 kgs per cubic meter

Finish options:

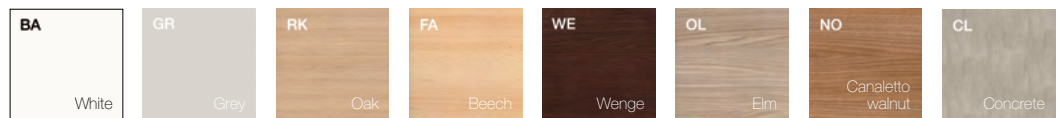

FRAME

Frame made from epoxy powder coated steel tube complete with ø60mm twin wheel lockable castors. Frame linked to the top using 2.5mm steel plates, metal-to-metal fixings. Heavy duty release & flip mechanism.

Finish options:

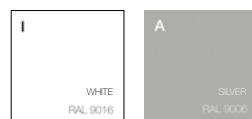

LINKING PLATES

Linking plates for back-to-back and end-to-end, we recommend to order linking plates when levelling of tables is required.



TECHNICAL FEATURES

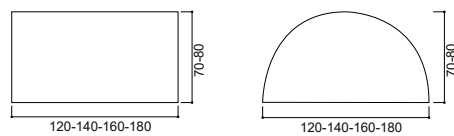

SUSTAINABILITY & CERTIFICATIONS



MATERIALS AND RECYCLABILITY

MFC panels used for flip-top tables are solely manufactured with 100% recycled wood and fully meet requisites of formaldehyde low emissions (E1 Quality Award Formaldehyde CATAS Certificate). Resins used for panels and melamines are free of SVHC substances (to be found in the ECHA list updated as of 12/01/2017).



CERTIFICATIONS

Constantly receptive to market requirements, Quadrifoglio Group pay special attention on quality and safety contents in order to provide high products and services. The Company has reached certifications UNI EN ISO 9001/2008, UNI EN ISO 14001/2004 and BS OHSAS 18001/2007 to confirm his policy. Our products are certified and ensured by FSC™ and ECOLOGICAL PANEL.

COMPANY WITH
MANAGEMENT SYSTEM
CERTIFIED BY DNV GL
= ISO 9001 =
= ISO 14001 =
= OHSAS 18001 =



GREEN ENERGY

The Company had installed the photovoltaic system with 4,500 solar panels in a 7.350 m² surface that covers almost entirely the factory. The photovoltaic is able to produce 1Mw of a quiet green energy, that does not harm the environment and is waste-free. With his high production capacity the photovoltaic allows us to reduce emissions in the atmosphere of all those polluting substances and to those that contribute to the greenhouse effects. Consequently, such measures make us save every year 180 tonne of petrol oil, 440 tonne of CO₂, 514kg of sulphur dioxide, 448 kg of nitrogen oxide and 23kg of dust.



TRANSPORT

Packaging is reduced in order to decrease volumes. Goods collections are responsibly managed and organised with the aim of optimise transports, reducing atmosphere emissions.